

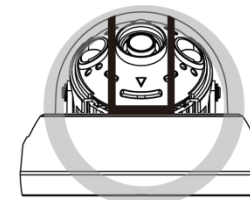

TVI + Starvis

Anti-reflection Light Easy Ceiling Wall indoor IR 02

Resolution	1080P, 720P
Lens	Fixed lens 3.6mm, 4mm, 6mm
Sensor	1/2.8 inch SONY CMOS (IMX-291)
Pixels	Total : 1945(H) x 1109(V) = 2.16M / Effective : 1945(H) X 1097(V) = 2.13M
Scanning System	PROGRESSIVE
S/N (Y signal)	More than 52 dB (AGC Off)
Video Output	TVI, AHD, CVI, CVBS: 1.0Vp-p (75ohm) : Option
Min.Illumination	0 Lux at IR On (IR LED 02)
White Balance	Auto / Auto Ext / Preset / Manual
Electronic shutter speed	AUTO / MANUAL (1/30sec ~ 1/30,000sec) / FLICKER
Function	DNR / ACE / WDR / BLC / HLC / Sens_up / Privacy / Flip / Motion / Defog / RS-485 / Sharpness / Smart IR / Brightness
Day & Night	AUTO (Day <-> Night TIME Change) , COLOR , B/W, EXTERN
Language	ENG, CHN, CHN(S), JPN, KOR
Temperature/Humidity	Operating (-10°C~+50°C / 30%~80% RH) / Storage (-20°C~+60°C / 20%~90% RH)
Power	DC12V [AC24V / DC12V DualPower (option)]
signal Transmission	The distant difference is occurred according to cable option and other circumstances.

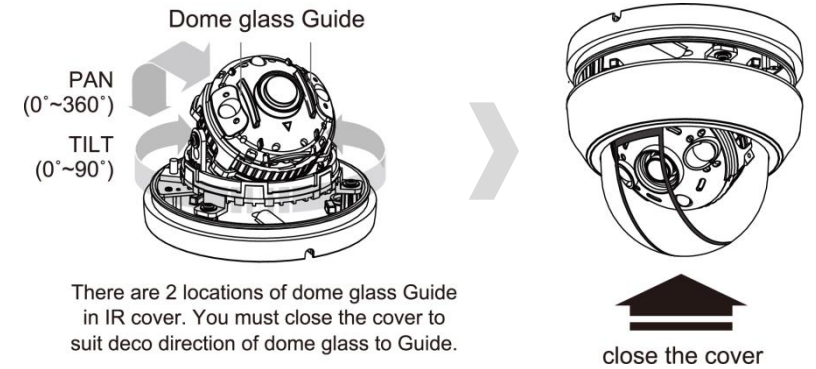
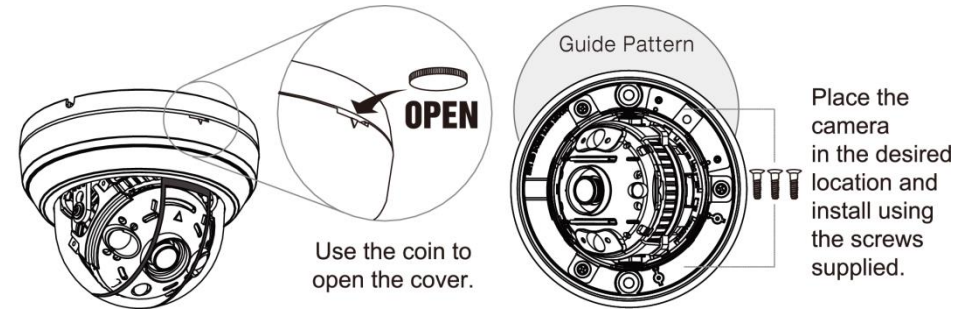

Right Assembly

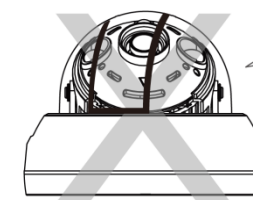

Wrong Assembly

If the combination of the hemisphere is wrong, the diffuse reflection may occur. Please check the combination direction of Hemisphere if the diffuse reflection occurs.