

i5V7-RW-M2812

NDAA/TAA
Compliant product



*MAGIC IP H.265 ONVIF

- 5MP (2592x1944), Dual Stream
- Video Encoding H265/ H264
- 2.8~12mm Motorized V/F lens
- Hi-power LED 4pcs (IR Range 40M)
- 0.01 Lux (color), WDR, 3D DNR, AWB
- 2way Audio(G711U/G711A coding), Alarm, Sensor
- IE6.0 and Above Browser/ P2P Cloud Service
- Built in SD card slot
- Anti-reflection shield dome
- IP68, 3-Axis inner bracket
- EASY Installation (Ceiling, Wall bracket option)

SPECIFICATIONS

Image Sensor	1/2.8" SONY CMOS	
Resolution	2592(H) x 1944(V), 5MP	
Lens	2.8~12mm (F1.4) Motorized V/F lens	
LED	Hi-power 4pcs (IR Range 40M)	
Video Compression	H.265 / H.264	
Video Bit rate	CBR / VAR	
Frame Rate	Main Stream	2592*1944, 2688*1520, 2560*1440, 2048*1520, 2304*1296, 1080P/720P@30Fps
	Sub Stream	D1/ VGA/ 640*360/ CIF@30fps
Shutter speed	Auto / Manual	
Day & Night	Automatic, External control, Manual, Timing	
Function	3D DNR/ WDR (120dB) / BLC/ Privacy Mask, Flip mode, Saturation, Brightness, Contrast, Hue, Sharpness adjustable, AWB, Anti-face over-exposure , Defog	
Network	IE6.0 , Safari, Chrome, FireFox, Opera, Edge Browser	
Protocol	HTTP / RTSP / DHCP / NTP / ONVIF, optional GB28181, RTMP	
System Compatibility	ONVIF T v17.06 (TBD)	
Interface	RJ45	
SD Storage	max. 128GB	
Audio in/out	Support, Codec G711U/G711A	
Alarm / Sensor / PoE	Support	
Power Supply	DC12V	
Temperature/Humidity	Operating (-10~ +50°C / 30~80% RH)	

DIMENSIONS (mm)

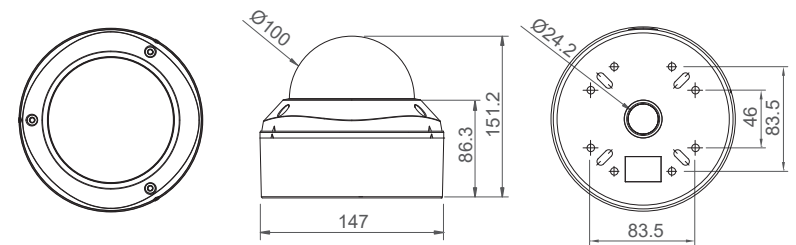

INSTALLATION

- Place the the surface mount at the pre-drilled installation position and route the power/network cable.
- Fix the surface mount by using mounting screws.
- Attach the flush mount to the surface mount.
- Adjust the camera's viewing angle (Pan, Tilt, Rotation)
- Assemble the dome cover to suit direction of dome glass guide.
- Tighten screws with L-wrench to fix the camera.

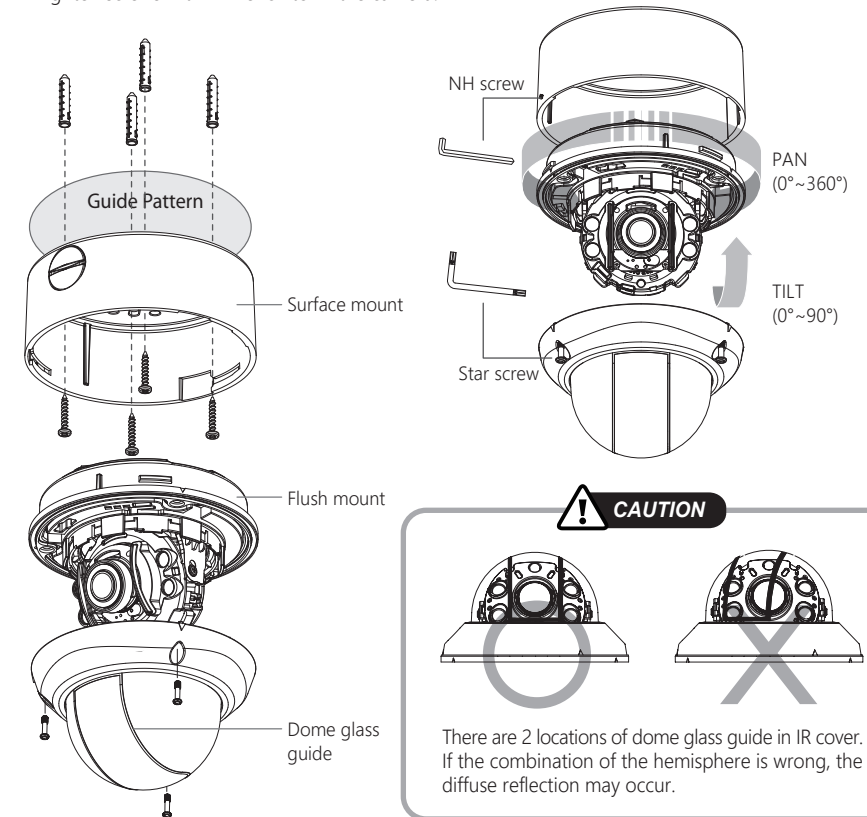

There are 2 locations of dome glass guide in IR cover. If the combination of the hemisphere is wrong, the diffuse reflection may occur.